

NOTICE OF CLASS ACTION LAWSUIT

The Circuit Court of Prairie County approved this Notice. This is not a solicitation from a lawyer.

This notice is given pursuant to Rule 23 of the Arkansas Rules of Civil Procedure and pursuant to an Order of Honorable Bynum Gibson, Judge of the Circuit Court of Prairie County, Arkansas. A lawsuit is pending titled, *Paul Betzner & Rhonda Betzner, The Calvin Fred Betzner Revocable Trust, James Alberson and Tiffani Alberson, Tiffani Alberson as Parent and Next Friend of M.J., a Minor, Kelly Kelley, Tony Patterson, City of Fredonia a/k/a City of Biscoe, on behalf of all others similarly situated v. C. J. Mahan Construction Company, LLC, Parsons-Mahan Joint Venture, Parsons Construction Group, Inc., Anthony Cruz, Scott Richardson, Chris Gentry and Bryan Hoffman*, In the Circuit Court of Prairie County, Arkansas, No. 2017-38.

Plaintiffs contend that between September 1, 2017 and September 6, 2017, raw sewage totally infiltrated the City of Biscoe Water System and parts of the East Prairie County Water Distribution Systems. In turn, raw sewage passed through the water meters and into the homes and businesses that received their water from these two public water systems. The Defendants are contractors that are working on the replacement of the Interstate 40 bridges over the White River. The infiltration was caused by the cross connection of damaged water and sewer lines at the tourist information centers on Interstate 40 near the White River. The Defendants have admitted they cross connected the water and sewer lines but deny the raw sewage totally infiltrated the City of Biscoe and East Prairie County Water distribution systems and deny they caused any damages. Plaintiffs are seeking property damages and damages for personal injury due to the exposure to the sewage in their homes and businesses. A trial will be held in the Circuit Court of Prairie County, Arkansas, at the Des Arc Courthouse. No money has been collected and there is no guarantee there will be funds available for class members. However, your rights are affected and you have a choice to make now.

YOUR RIGHTS AND OPTIONS IN THIS LAWSUIT	
DO NOTHING	You do not need to do anything at this time if you are choosing to stay in the lawsuit. You will keep your right to share in any possible money or benefits that may come from the trial or settlement. But, you are giving up your right to sue the Defendants in a different lawsuit about the same legal claims as that asserted in this lawsuit. If you remain in the lawsuit, you will be unable to subsequently sue the Defendants about the same claims in this case regardless of the outcome.
ASK TO BE EXCLUDED	If you ask to be excluded from this lawsuit, you will not be eligible to share in any money or benefits which may be awarded by a jury or by settlement. You will keep the right to sue Defendant in a different lawsuit about the same legal claims asserted in this lawsuit. You must act by July 2, 2021 to be excluded in the manner set forth in this notice.

**Questions? Call 501-315-7491 or 501-404-2333 or visit www.BiscoeWaterClassAction.com
DO NOT CALL THE COURT WITH QUESTIONS**

WHAT THIS NOTICE CONTAINS

BASIC INFORMATION.....3

- 1. Why is there a notice?
- 2. Why is this lawsuit a class action?

MEMBERS OF THE CLASS.....3

- 3. Who is a potential class member?

THE CLAIMS IN THE LAWSUIT.....4

- 4. What is this lawsuit about?
- 5. What happened so far in the case?
- 6. What are Plaintiffs asking for on behalf of the class?
- 7. Is there money available now?

THE LAWYERS APPOINTED TO REPRESENT THE CLASS.....6

- 8. Do I have a lawyer in the case?
- 9. Should I get my own lawyer?
- 10. How will the Class Counsel be paid?

THE TRIAL.....7

- 11. How and when will the court decide the case?
- 12. Do I have to come to trial?
- 13. Will I get money after the trial or settlement?

YOUR RIGHTS AND OPTIONS.....7

- 14. What happens if I do nothing at all?
- 15. What happens if I exclude myself?
- 16. How do I ask to be excluded?

GETTING MORE INFORMATION.....9

- 17. Is more information about the lawsuit available?

APPENDIX.....11-14

- Exhibit 1-Biscoe Water System Customer List
- Exhibit 2- East Prairie County Water System Customer List
- Exhibit 3- Biscoe Water System Map of Affected Areas
- Exhibit 4- East Prairie County Water System Map of Affected Areas.

**Questions? Call 501-315-7491 or 501-404-2333 or visit www.BiscoeWaterClassAction.com
DO NOT CALL THE COURT WITH QUESTIONS**

BASIC INFORMATION

1. WHY DID I GET THIS NOTICE?

This Notice was issued because the Court has “certified” this case as a class action lawsuit and your rights may be affected. If you owned a home, business, church or other structure that received water from the City of Biscoe or parts of the East Prairie County Water Distribution System during September 1, through September 6, 2017, or resided in a home, business, church or other structure during that time, you may have legal rights and options in this case before the Court decides whether the claims being made on your behalf are correct. This notice explains all these things.

The Honorable Bynum Gibson, Special Circuit Judge of the Circuit Court of Prairie County, Arkansas (the “Court”) is overseeing this class action. The case is known as *Betzner, et al, v. C.J. Mahan, et al*, In the Circuit Court of Prairie County, Arkansas, No. 2017-38.

2. WHY IS THIS A CLASS ACTION LAWSUIT?

In a class action, one or more persons called class representatives sue on behalf of people who have similar claims. All persons, businesses, trusts, corporations, partnerships, limited liability companies or other entities who have similar claims collectively make up the “Class” and are called “Class Members.” One lawsuit before one judge resolves the issues and claims for all Class Members together.

The Court decided that this lawsuit constituted a class action under the requirements of the Arkansas Rules of Civil Procedure Rule 23. More information about why this is a class action can be found in the Court’s Class Certification Order which is available at www.BiscoeWaterClassAction.com. The Court has authorized this Notice, but it is not an expression of an opinion by the Court as to the merits of any of the claims or defenses asserted by either side in the case.

MEMBERS OF THE CLASS

3. WHO IS A POTENTIAL CLASS MEMBER?

Generally, if you or an entity which you control owned a home, business, church or other structure that was connected to the City of Biscoe Water System or parts of the East Prairie County Water Association during the time period from September 1, 2017 through September 6, 2017, you, or the entity you control, is a potential class member.

Additionally, if you lived or resided in a home that was connected to the City of Biscoe Water Distribution System, or parts of the East Prairie County Water Association at anytime during the time period from September 1, 2017 through September 6, 2017, you, and all members of your household, are potential members of the Class.

The Court has defined the class as follows:

1) The Biscoe Water System (BWS) and the East Prairie County Water System (EPCWS).

**Questions? Call 501-315-7491 or 501-404-2333 or visit www.BiscoeWaterClassAction.com
DO NOT CALL THE COURT WITH QUESTIONS**

2) the BWS and EPCWS customers, per exhibit 1 and 2, and those natural persons residing in dwellings or structures that those accounts service.

3) the property owners during September 1-September 6, 2017, as shown by the records of the Recorded for Prairie County and which were serviced by the 329 accounts listed in Plaintiffs' Exhibit 1 and 2. Plaintiffs' Exhibits 3 and 4 are maps showing the real property locations.

The exhibits referenced in the class definitions are attached to this Notice as an appendix. Those exhibits are the following:

- Exhibit 1- Biscoe Water System Customer List
- Exhibit 2- East Prairie County Water System Customer List
- Exhibit 3- Biscoe Water System Map of Affected Areas
- Exhibit 4- East Prairie County Water System Map of Affected Areas.

You should read the class definitions carefully and then consult Exhibits 1-4 to see if your name appears on the customer list. If it does, you are likely a Class Member. If you have questions, you may call, write or inquire of Class Counsel.

THE CLAIMS IN THE LAWSUIT

4. WHAT IS THIS LAWSUIT ABOUT?

Plaintiffs own or reside in homes that received their water from either the City of Biscoe or parts of the East Prairie County Water Distribution systems during September 1, 2017 through September 6, 2017. Defendants have admitted they cross connected the water and sewer lines at the State of Arkansas Tourist Information Centers located west of the White River on Interstate 40 after the lines were damaged by excavation equipment. Plaintiffs allege the cross connection occurred because licensed plumbers were not called upon to make the necessary repairs.

Plaintiffs allege that when the State of Arkansas opened the Tourist Information Centers for the Labor Day holiday in 2017, raw sewage from the Tourist Information Centers was pumped into the City of Biscoe Water Distribution system and parts of the East Prairie County Water Distribution system that was connected to the City of Biscoe System. Plaintiffs claim that the sewage then passed through the water meters and into every structure that receives water from these distribution systems.

Plaintiffs make the following claims: 1) that the Defendants recklessly and unlawfully cross connected the water and sewer lines causing systemwide contamination; and 2) that the City of Biscoe is a third party beneficiary of the bridge construction contract between the Arkansas Highway Department and Defendants that expressly requires the Defendants to perform the bridge construction in compliance with all laws and regulations for the public and the public's protection.

Plaintiffs claim both property and personal injury damages as a result of the sewage entering their homes, churches, businesses and other structures that received water from these water distribution systems. Plaintiffs claim that all private water systems inside their homes, businesses, churches and other structures now violate Section 608.10 of the Arkansas Plumbing Code which states:

608.10. Reuse of Piping. Piping that has been utilized for any purpose other than conveying potable water *shall not be utilized* for conveying potable water.

**Questions? Call 501-315-7491 or 501-404-2333 or visit www.BiscoeWaterClassAction.com
DO NOT CALL THE COURT WITH QUESTIONS**

Plaintiffs claim that the value of every structure that received water from either the City of Biscoe or parts of East Prairie County Water system is diminished because of the alleged violations of the Arkansas State Plumbing Code. Plaintiffs also claim that the entire plumbing systems in these structures must be replaced as well as ice makers, hot water tanks, dishwashers, washing machines and other appliances that use water. Plaintiffs claim that if the repairs are not made, and the structures are ever listed for sale with a realtor, that the sewage infiltration must be disclosed on a Property Disclosure Statement or its owner/seller would be guilty of defrauding his or her purchaser.

5. WHAT HAS HAPPENED SO FAR IN THE CASE?

The action was filed on September 18, 2017, in the Circuit Court of Prairie County, Arkansas. The Defendants answered the lawsuit and then removed it to federal court. The federal court then sent the case back to the Circuit Court of Prairie County Arkansas for adjudication.

On April 8, 2020, the Circuit Court of Prairie County, Arkansas, granted the Plaintiffs' Motion to Certify the Class. The Defendants appealed the decision to the Arkansas Supreme Court which, on March 4, 2021, upheld the ruling of the Prairie County Circuit Court. The Supreme Court did not consider the merits of the case but only whether it was appropriate for the case to be brought as a class action.

Plaintiffs and Defendants have taken many depositions (sworn statements) of many fact and expert witnesses. Experts who will testify on behalf of both parties have been disclosed. Written exchange of documents that are relevant to the case have been exchanged. The case is ready for trial.

The Defendants have admitted as a matter of law that they were negligent when they cross connected the water and sewer lines. They deny that Plaintiffs have been damaged in any way or that the infiltration was systemwide. The first trial is set to begin in August 2021.

6. WHAT ARE PLAINTIFFS ASKING FOR ON BEHALF OF CLASS MEMBERS?

Plaintiffs are seeking judgment against the Defendants in favor of Plaintiffs and the Class. A favorable judgment could include an award of some or all of the following monetary damages:

- a) Actual, compensatory, consequential and general damages to replace the public and private potable water plumbing systems and appliances that were connected to water systems inside of any home or structure that received water from the City of Biscoe and parts of the East Prairie County Water Association for the time period of September 1, 2017 through September 6, 2017;
- b) Actual, compensatory, consequential and general damages for bodily exposure to the sewage that entered the homes and other structures during the time period of September 1, 2017 through September 6, 2017;
- c) Actual, compensatory and general damages for medical treatment because of the bodily exposure to the sewage that entered the homes and other structures;
- d) Punitive Damages for reckless conduct in making the cross connection;
- e) Pre and Post judgment interest;

**Questions? Call 501-315-7491 or 501-404-2333 or visit www.BiscoeWaterClassAction.com
DO NOT CALL THE COURT WITH QUESTIONS**

- f) Reasonable attorneys' fees;
- g) Costs and Reimbursement of this lawsuit; and
- h) Any and all other relief that the Court deems proper.

7. IS THERE ANY MONEY AVAILABLE NOW?

There is no money available now. The lawyers for the Plaintiffs will present their claims and the lawyers for the Defendants will present their defenses at trial. If Plaintiffs win, there may be money awarded against the Defendants. The Court would then determine how to distribute these funds. However, there is no guarantee that any money will ever be awarded or obtained. If Defendants prevail, there will be no recovery and you will not be able to make any further claim for damages alleged in this lawsuit if you do not exclude your claim as provided for in this Notice.

THE LAWYERS APPOINTED TO REPRESENT THE CLASS

8. DO I HAVE A LAWYER IN THIS CASE?

The Court appointed the following attorneys to serve as Class Counsel to represent you and other Class Members. They are experienced in handling similar cases.

Hall and Taylor Law Partners, PLLC
415 North McKinley Suite 1000
Little Rock AR 72205
501-404-2333
email: Randy@littlerocktriallawyers.com
Mattie@littlerocktriallawyers.com

Lovell, Nalley and Nalley
501 North Main Street
Benton AR 72015
501-315-7491
email: johndoynalley@hotmail.com
email: cwnalley1@gmail.com

9. SHOULD I GET MY OWN LAWYER?

You do not need to hire your own lawyer because Class Counsel has been appointed by the Court to represent you and all other members of the Class. If you desire individual representation, you can hire your own lawyer at your own expense. Class Counsel will represent the Class and not individual Class Members.

10. HOW WILL CLASS COUNSEL BE PAID?

You will not be responsible to pay any of the fees or expenses no matter what the outcome of the lawsuit. If Class Counsel obtains money for the Class, they will ask the Court for fees and expenses. If the Court grants the request, the fees and expenses will be either deducted from the money obtained for the Class or paid separately by the Defendants.

**Questions? Call 501-315-7491 or 501-404-2333 or visit www.BiscoeWaterClassAction.com
DO NOT CALL THE COURT WITH QUESTIONS**

THE TRIAL

11. HOW AND WHEN WILL THE COURT DECIDE THE CASE?

The case will be decided at the trial which will be held at the Prairie County Courthouse in Des Arc, Arkansas. The first trial is set for August 2, 2021.

12. DO I HAVE TO COME TO THE TRIAL?

It is not yet certain whether your attendance will be required or not. The case involves individual property damages to both your home, business or structures and personal injury damages because you were personally exposed to sewage in your home. Your presence to identify your individual damages may be required. You will receive an additional notice if your attendance is necessary at trial.

13. WILL I GET MONEY AFTER THE TRIAL OR SETTLEMENT?

If Class Counsel obtains a monetary recovery for the Class as a result of a trial or settlement, you will be notified about how to participate in the recovery. Updated information about the case may be posted on www.BiscoeWaterClassAction.com.

YOUR RIGHTS AND OPTIONS

14. WHAT HAPPENS IF I DO NOTHING AT ALL?

If you do nothing right now, you are choosing to stay in the Class. If the Plaintiffs win or lose at trial, you will be legally bound by all orders and judgments of the Court. You will not be able to sue Defendants, in a different case, over the legal claims that are or could have been included in this action. If there is a recovery, you may be entitled to share in the proceeds, less such costs, expenses and attorneys' fees that the Court may allow out of such recovery. If Defendant wins this litigation, there will be no recovery and you will not be able to make any further claim for damages based in the lawsuit. Do not request exclusion if you wish to participate in this lawsuit as a Class Member.

15. WHAT HAPPENS IF I EXCLUDE MYSELF?

If you exclude yourself from the Class, you will not be bound by any judgment in this lawsuit, nor will you be entitled to share in any recovery in this lawsuit. You may individually pursue any legal rights you may have against the Defendants at your own expense. If you do exclude yourself so you can start or continue your own lawsuit against Defendant, you should talk to your own personal lawyer immediately because your claims may have a statute of limitations.

16. HOW DO I ASK TO BE EXCLUDED?

You must send a valid "Exclusion Request" in the form of a written letter sent by mail, stating that you want to be excluded from *Betzner, et al. v. C.J. Mahan Construction Company, LLC, Case NO. 2017-38*. To be valid, your Exclusion Request must timely received and include the following:

For Property Owners Excluding From Property Damage Claims:

- (1) state the legal owner's name, address and telephone number;
- (2) state your title (if owned by a corporation, you are president; if owned by a trust, you are the trustee, etc.) or other authority upon which you are completing the Exclusion Request;
- (3) be signed by you and include your printed name;
- (4) Include a notarized statement that you are choosing to opt out and exclude your property from damage claims.

Please Note:

(A) If your real estate is owned by two or more people, both/all owners must opt out using the above procedures to exclude your property from damage claims. If one of the owners fails to properly opt out, the property will not be excluded and will be included in this class action.

(B) If your real estate is owned by a corporation, limited liability company, partnership, estate, trust or other entity, you must include documents that indicate you are authorized to make the opt out or Exclusion Request. Examples of Documents that verify your authority are the following:

Corporation:	Board Resolution, or other documents that verify you are an officer of the corporation;
Limited Liability Company:	Operating Agreement, Resolution of Members or other documents that verify you are a manger of the LLC;
Trust:	Trust Agreement, Trust Memorandum or other documents that verify you are the trustee;
Estate:	Letters of Administration issued by a probate court.

For Natural Persons Excluding From Exposure Claims:

- (1) State your full name, age, address and telephone number;
- (2) State the full name, age and telephone number of all persons who resided in your home during September 1, 2017 through September 6, 2017.
- (3) be signed by you and include your printed name;
- (4) Include a notarized statement that you are choosing to opt out and exclude yourself from personal injury claims.

Please Note:

(A) Any and all persons who resided in your home during September 1, 2017 through September 6, 2017 must complete and sign their own Exclusion Form to opt out of the personal injury claims.

(B) If you are making an exclusion for a person under the age of 18 years, or a person that is mentally incapacitated for any reason, you must state your relationship to the person, and include a notarized statement that you are the natural or adoptive parent of the minor or have guardianship over the person who is incapacitated. If you are making the exclusion because you are a court appointed guardian, include a copy of your Letters of Guardianship issued by the probate court.

**Questions? Call 501-315-7491 or 501-404-2333 or visit www.BiscoeWaterClassAction.com
DO NOT CALL THE COURT WITH QUESTIONS**

All Exclusion Requests must be postmarked by July 2, 2021 and mailed to the following address:

John Doyle Nalley and Randy Hall
P.O. Box 606
Benton Arkansas 72018

If your exclusion request is not postmarked by July 2, 2021, you will be considered a Class Member and you will be bound by any final judgment in this lawsuit.

Please Note:

- (A) Emails or phone calls requesting exclusion will NOT be accepted.
- (B) All Exclusion Requests must be submitted as originals. Copies will NOT be accepted.

GETTING MORE INFORMATION

17. IS THERE MORE INFORMATION ABOUT THE LAWSUIT AVAILABLE?

This Notice gives only a summary of the lawsuit and the claims and defenses asserted by the parties. More information about the lawsuit is available by visiting [www. BiscoeWaterClassAction.com](http://www.BiscoeWaterClassAction.com), calling **501-315-7491 or 501-404-2333** or writing to any of the following:

Hall and Taylor Law Partners, PLLC
415 North McKinley Suite 1000
Little Rock AR 72205
501-404-2333
email: Randy@littlerocktriallawyers.com
Mattie@littlerocktriallawyers.com

Lovell, Nalley and Nalley
501 North Main Street
Benton AR 72015
501-315-7491
Email: johndoylenalley@hotmail.com or
Email: cwnalley1@gmail.com

DATE: May 10, 2021

By ORDER OF THE CIRCUIT COURT
PRAIRIE COUNTY CIRCUIT COURT
CIVIL DIVISION

**Questions? Call 501-315-7491 or 501-404-2333 or visit www.BiscoeWaterClassAction.com
DO NOT CALL THE COURT WITH QUESTIONS**

EXHIBIT "1"

BISCOE WATER
SYSTEM CUSTOMER
LIST

Billing Register

WATER
9/26/2017 4:20:06PM

Act	Rt	Name	Usage	Readings	Water	SEWAGE	SANITA	Late C.	Recomm	Adjust	PWS Fee	Tax	Past Due	Total
176	1	Alberson, Bobby	3,900	7750	7789	17.70	18.70	13.46			0.30	2.49	77.28	129.93
79	1	Alberson, Lori	7,300	13752	13825	27.33	28.33	13.46			0.30	3.26		72.68
157	1	Alberson, James	0	400	411			Exclude						0.00
34	1	Angie Newton	0	68444	68459									0.00
222	1	ARK. STATE HIGHWA	98,600	616837	617823	Exclude	244.85	Exclude			Exclude	Exclude		244.85
223	1	ARK. STATE HIGHWA	2,000	253790	253810	28.00	22.00	Exclude			0.30	2.24		52.54
168	1	Baxter, Timmy	0	0	0	Exclude	12.36				Exclude	0.99		13.35
277	1	BEITZNER, PAUL	0	0	0									0.00
162	1	Biazok, Joseph	0	1158	1205									0.00
144	1	Bonds Michael	3,600	1573	1609	16.80	17.80	13.46	7.73		0.30	2.42	80.98	139.49
35	1	BONDS, BARBARA	6,500	11149	11214	25.13	26.13	13.46	10.77		0.30	3.09	12.29	91.17
43	1	BONDS, BOBBY	6,600	8035	8101	25.40	26.40	13.46	7.62		0.30	3.11	79.77	156.06
237	1	BONDS, CARL	700	7721	7728	18.00	Exclude	12.36	3.68		0.30	2.43	(3.68)	33.09
59	1	BONDS, JEROME	2,400	10659	10683	13.20	14.20	13.46			0.30	2.13		43.29
53	1	BONDS, JOYCE	8,400	11896	11980	30.35	31.35	13.46			0.30	3.50		78.96
11	1	Bonds, Jr. Bobby	900	2393	2402	12.00	13.00	13.46			0.30	2.04		40.80
38	1	Burroughs, Dorothy	0	0	0	Exclude		12.36			Exclude	0.99		13.35
285	1	BURTON, ORLANDO	5,500	6843	6898	22.38	23.38	13.46			0.30	2.87		62.39
58	1	CAMPBELL, MARK	2,200	38	60	12.60	13.60	13.46	5.88		0.30	2.08	61.68	109.60
16	1	CAMPBELL, THELM	700	1974	1981	12.00	13.00	13.46			0.30	2.04		40.80
116	1	Carl Bonds	3,200	7143	7175	15.60	Exclude	13.46	7.72		0.30	2.32	83.04	122.44
128	1	Casa Blanca LLC	100	1942	1943	18.00	Exclude	Exclude	0.60		0.30	1.44	6.46	26.80
146	1	Cazer, Larry or Barbara	2,300	2383	2406	12.90	13.90	13.46			0.30	2.11		42.67
140	1	Chapman, Pat	2,000	8869	8889	12.00	13.00	13.46			0.30	2.04		40.80
3	1	CHURCH OF CHRIST	600	612	618	12.00	13.00	13.46			0.30	2.04		40.80
19	1	CHURCH OF GOD IN I	600	2791	2797	12.00	13.00	13.46			0.30	2.04		40.80
256	1	CHURCH, A/GOD FS I	0	0	0	12.00	13.00	13.46			0.30	2.04		40.80
121	1	CHURCH, ASSEMBL	4,400	1336	1380	19.20	20.20	13.46			0.30	2.61		55.77
95	1	CHURCH, BAPTIST F	200	1818	1820	12.00	13.00	13.46			0.30	2.04		40.80
55	1	CHURCH, BETHLEHE	2,600	1541	1567	13.80	14.80	13.46			0.30	2.18		44.54
96	1	CHURCH, FIRST BAP	4,000	1466	1506	18.00	19.00	13.46			0.30	2.52		53.28
62	1	CHURCH, ST JOHNS	100	63	64	12.00	13.00	13.46			0.30	2.04	(0.32)	40.48
105	1	Clark, Bo & Danese	0	0	0	Exclude		12.36			Exclude	0.99		13.35
170	1	Cohen, Peggy Ann	2,200	8531	8553	12.60	13.60	13.46	5.81		0.30	2.08	(3.03)	44.82
209	1	COHEN, STACEY	2,300	1867	1890	12.90	13.90	13.46	6.36		0.30	2.11	(6.36)	42.67
21	1	Cook, Joe	1,800	5333	5351	12.00	13.00	13.46			0.30	2.04		40.80
73	1	COOK, MIKE	1,400	10483	10497	12.00	13.00	13.46			0.30	2.04		40.80
103	1	DABBS JR. CLAUDE	0	5268	5288			13.46			0.30	2.04	60.65	60.65
4	1	Dampier, Doris & Gary	4,400	7417	7461	19.20	20.20	13.46			0.30	2.61		55.77
202	1	Dixon, Bryan	1,900	7755	7774	12.00	13.00	13.46			0.30	2.04		40.80
141	1	F, Hunter	3,900	3938	3977	17.70	18.70	13.46			0.30	2.49	(1.41)	51.24
259	1	N, KEITH	0	0	0			2.36			0.99		(16.11)	(2.76)

Act	Rt	Name	Usage	Readings	Water	SEWAGE	SANTA	Late C.	Reconn	Adjust	PWSFee	Tax	PastDue	Total
107	1	DIXON, JELAND	2,800	2404	2432	14.40	15.40	13.46			0.30	2.23		45.79
81	1	Dooley Rd. Biscoe Lan	100	14965	14966	12.00	13.00	13.46			0.30	2.04		40.80
173	1	Dooley, Bill I	9,500	26	121	33.25	34.25	Exclude			0.30	2.66	47.14	117.60
44	1	DOOLEY, DOUG	0	4454	4459									0.00
166	1	Dooley, Jason	0	687	922			Exclude						0.00
143	1	Dooley, Teddy	2,200	6710	6732	12.60	13.60	13.46			0.30	2.08		42.04
126	1	Douglas, Mike	0	17	17		Exclude	Exclude						0.00
63	1	Douglas, Martin	5,300	2458	2511	21.83	22.83	13.46			0.30	2.82		61.24
7	1	Dupuy Tim	0	20	20	18.00	Exclude	Exclude	5.94		0.30	1.44	63.91	89.59
210	1	Eagle, Bobby	0	1087	1087	18.00	Exclude	Exclude			0.30	1.44		19.74
33	1	EVANS, BEN	800	6916	6924	18.00	Exclude	Exclude			0.30	1.44		19.74
27	1	Falcon, Jon	0	8714	8714	18.00	Exclude	Exclude	0.12		0.30	1.44	1.30	21.16
147	1	Farmers Association Wa	21,800	14558	14776	62.05	Exclude	Exclude	Exclude		0.30	4.96		67.31
119	1	Farris, Rita	0	0	0	Exclude	Exclude	12.36	Exclude		Exclude	0.99		13.35
20	1	FINKLEA, EMMA	5,900	10308	10367	23.48	24.48	13.46	7.26		0.30	2.96	(7.26)	64.68
72	1	Ford, Tim	0	10	10	18.00	Exclude	Exclude			0.30	1.44		19.74
85	1	Foster Jr. Will	0	616	616									0.00
75	1	FOSTER, SADIE	100	5291	5292	12.00	13.00	13.46			0.30	2.04		40.80
32	1	Foster, Wilma Ann	2,500	5638	5663	13.50	14.50	13.46			0.30	2.16		43.92
283	1	GAYIN, BYRON 2	200	3330	3332	12.00	13.00	13.46			0.30	2.04		40.80
42	1	GEANS, ADDIE	2,500	15173	15198	13.50	14.50	13.46	21.64		0.30	2.16	85.42	150.98
163	1	GEANS, CHRISTINE	700	9668	9675	12.00	13.00	13.46	6.20		0.30	2.04	5.11	52.11
68	1	Glaston, Deangelo	0	3034	3036									0.00
48	1	Glenn, Lamar 5	0	0	0									0.00
151	1	Gowan, Brian	3,200	514	546	15.60	16.60	13.46			0.30	2.32		48.28
9	1	Griffin, Donnie	0	0	0	Exclude	Exclude	12.36	1.24		Exclude	0.99	13.35	27.94
132	1	GURLEY, JARRETT &	2,900	7429	7458	20.70	Exclude	Exclude			0.30	1.66		22.66
174	1	Hall, Cody	1,300	6218	6231	12.00	13.00	13.46			0.30	2.04		40.80
114	1	Hall, Daisy	500	259	264	12.00	13.00	13.46			0.30	2.04		40.80
6	1	HALL, KYLE	5,100	944	995	21.28	22.28	13.46	9.00		0.30	2.78	(9.00)	60.10
234	1	Hampton, Irene	2,000	904	924	12.00	13.00	13.46			0.30	2.04		40.80
115	1	HARDEN, CHARLIE	2,100	759	780	12.30	13.30	13.46			0.30	2.06		41.42
171	1	Harold Bonds Kidling I	0	55	57	Exclude	Exclude	Exclude			Exclude			0.00
13	1	Harris, Everlena	4,700	1795	1842	20.10	21.10	13.46	7.08		0.30	2.68	(7.84)	56.88
86	1	HARRIS, LAWRENCE	3,100	7243	7274	15.30	16.30	13.46			0.30	2.30		47.66
185	1	Hendy, Faye	1,500	6643	6658	12.00	13.00	13.46			0.30	2.04		40.80
98	1	Holloway, Vince & Ni	6,600	6067	6133	33.10	Exclude	13.26			0.30	3.48		50.14
131	1	HOLLOWAY, LARRY	3,000	7872	7902	15.00	16.00	13.46			0.30	2.28		47.04
192	1	HOLMES, CHARLES	9,200	881	973	Exclude	33.50	13.46			Exclude			46.96
260	1	HOLT, MICHAEL B.	0	2076	2076	18.00	Exclude	Exclude			0.30	1.44		19.74
238	1	HOLZHAUER, DAVID	800	1987	1995	18.00	Exclude	Exclude	Exclude		0.30	1.44	(31.42)	(11.68)
169	1	House, Ronnie 0	6,300	11	74	24.58	25.58	13.46			0.30	3.04		66.96
235	1	HUMBERT, EULA JE	8,800	10730	10818	31.45	32.45	13.46			0.30	3.59		81.25
5	1	Hutchinson, Joe D	3,200	7142	7174	15.60	16.60	13.46			0.30	2.32		48.28
142	1	Jr. n, Clifford	3,500	3198	3233	16.50	17.50	13.46			0.30	2.40		50.16

Act	Rt	Name	Usage	Readings	Water	SEWAGE	SANITA	Late C	Reconn	Adjust	PWSFee	Tax	PastDue	Total
94	1	Jackson, Clifford G	0	3417	3481									0.00
66	1	JAMES HAROLD & L	30,300	15914	16217	81.18	82.18	13.46			0.30	7.57		184.69
136	1	JAMES, SHANNON	4,700	1287	1334	20.10	21.10	13.46	5.88		0.30	2.68	(5.88)	57.64
203	1	JARRETT, EVA	2,300	11704	11727	12.90	13.90	13.46			0.30	2.11	3.55	46.22
80	1	Jason Dooley lot 6	0	0	0									0.00
45	1	Jones Sullivan, Judy	8,500	8331	8616	30.63	31.63	13.46			0.30	3.53		79.55
39	1	Jones Tynus, Daisy M.	2,200	14696	14718	12.60	13.60	13.46			0.30	2.08		42.04
57	1	Jones, Calvin	1,400	7208	7222	12.00	13.00	13.46	6.46		0.30	2.04		114.82
49	1	JONES, FRANKIE	2,400	6935	6959	13.20	14.20	13.46	5.88		0.30	2.13	(5.88)	43.29
280	1	JONES, LOLA	2,700	6382	6409	14.10	15.10	13.46			0.30	2.20		45.16
61	1	JONES, MAXINE	900	5074	5083	12.00	13.00	13.46	5.88		0.30	2.04	(5.88)	40.80
182	1	JONES, MELISSA	6,600	20078	20144	25.40	26.40	13.46	7.95		0.30	3.11	13.95	90.57
254	1	JONES, PHYLLIS & L	3,700	3653	3690	17.10	18.10	13.46			0.30	2.44		51.40
12	1	Joshlin, Cordell	0	0	0									0.00
22	1	Joshlin, Riley	0	0	0			12.36	Exclude		Exclude	0.99	26.70	40.05
266	1	LANDRY, PAULA CH	8,100	13408	13489	29.53	30.53	13.46	12.13		0.30	3.44	126.65	216.04
194	1	LARKIN, PATRICIA	2,800	5582	5610	14.40	15.40	13.46	6.78		0.30	2.23	(6.78)	45.79
70	1	LARKIN, HAROLD	800	6729	6737	12.00	13.00	13.46			0.30	2.04		40.80
24	1	Larkin, Harold & Ruthi	2,400	2891	2915	13.20	14.20	13.46			0.30	2.13		43.29
124	1	Lee, Estelle	1,300	5974	5987	12.00	13.00	13.46			0.30	2.04		40.80
187	1	Lee, Henry	3,500	5526	5561	16.50	17.50	13.46			0.30	2.40		50.16
106	1	Lee, Robert Jacicie	4,600	4903	4949	19.80	20.80	13.46			0.30	2.66	(1.47)	55.55
189	1	Lightsey, Clara	900	1083	1092	12.00	13.00	13.46			0.30	2.04		40.80
191	1	Lightsey, Phillip	5,500	1846	1901	22.38	23.38	13.46	7.56		0.30	2.87	79.15	149.10
8	1	MARQUAND, KATH	1,200	4385	4397	12.00	13.00	13.46			0.30	2.04		40.80
89	1	Martin, Steve	1,900	1220	1239	12.00	13.00	13.46			0.30	2.04		40.80
287	1	MARTIN, STEVE	0	68213	68298			Exclude			Exclude			0.00
155	1	MASON JR, HARRY	8,300	14047	14130	30.08	31.08	13.46			0.30	3.48		78.40
161	1	Mason, Billy Diek	500	7355	7360	12.00	13.00	13.46			0.30	2.04		40.80
31	1	Mason, Billy D.	0	339	383			Exclude			Exclude			0.00
15	1	Mason, Billy Diek	0	61	61			Exclude			Exclude			0.00
50	1	Mason, Harry C.	0	3391	3397			Exclude			Exclude			13.00
109	1	Mayfield, John	600	5189	5195	18.00	Exclude	Exclude			0.30	1.44		0.00
76	1	McCool John	9,400	25389	25483	33.00	34.00	Exclude			0.30	2.64		19.74
87	1	McCool, Johnny	700	6879	6886	12.00	13.00	Exclude			0.30	0.96		69.94
77	1	McCoy, Richard	0	747	759			Exclude			0.30			26.26
97	1	McDaniel, 1 Bob	0	108	108			13.46			0.30	2.04		0.00
138	1	MILLER, CECIL	1,100	1700	1711	12.00	13.00	13.46			0.30	2.04		40.80
164	1	Miller, John 4	2,000	177	197	12.00	13.00	13.46			0.30	2.04		40.80
91	1	MILLS, CANDY	4,200	604	646	18.60	19.60	13.46	8.94		0.30	2.56	(8.94)	54.52
198	1	Mills, Gerald	400	11	15	12.00	13.00	13.46			0.30	2.04		40.80
30	1	MINOR, FELICIA	2,200	574	596	12.60	13.60	13.46	6.06		0.30	2.08	(6.06)	42.04
69	1	Minor, Hershel	2,600	4505	4531	13.80	14.80	13.46	6.37		0.30	2.18	(6.37)	44.54
289	1	NAIL, ERIC	4,100	6802	6843	18.30	19.30	13.46	3.19		0.30	2.54	33.35	90.44
108	1	N/ TODY	6,600	18898	18964	25.40	26.40	46			0.30	3.11		68.67

Acct	Rt	Name	Usage	Readings	Water	SEWAGE	SANITA	Late C	Reconn	Adjust	PWSFee	Tax	PastDue	Total
92	1	Orman, Patricia	0	25465	25482		Exclude						122.06	122.06
232	1	OSBORNE, PAUL	4,800	6095	6143	20.40	21.40	13.46			0.30	2.71		58.27
180	1	OVERTURE, GLEN	4,600	514	560	19.80	20.80	13.46			0.30	2.66		57.02
167	1	OVERTURE, R. P.	3,000	8808	8838	15.00	16.00	13.46			0.30	2.28		47.04
241	1	OWENS, JOHN	100	647	648	18.00	Exclude	Exclude			0.30	1.44		19.74
213	1	Owens, Johnny & Reg	4,700	29866	29913	20.10	21.10	13.46			0.30	2.68		57.64
282	1	PALTON, JONAS	5,800	586	644	23.20	24.20	13.46			0.30	2.93		64.09
217	1	Palton, Martha	0	4963	4998									0.00
118	1	Palton, Mattie	0	6867	6883								128.06	128.06
127	1	PALTON, NATHANIE	200	126	128	12.00	13.00	13.46			0.30	2.04		40.80
158	1	PALTON, ROBERT	2,500	5695	5720	13.50	14.50	13.46			0.30	2.16		43.92
172	1	PALTON, SHIRLEY	13,600	12600	12736	43.50	44.50	13.46			0.30	4.56		106.32
129	1	PATTERSON, MRS. J	11,500	2654	2769	Exclude	39.25	13.46		(17.35)	Exclude	1.08		36.44
71	1	Patterson, Anthony	0	5259	5273	Exclude					Exclude		19.21	19.21
101	1	PATTERSON, BILLY V	4,800	25136	25184	20.40	21.40	13.46			0.30	2.71		58.27
274	1	PATTERSON, TONY	11,600	1496	1612	38.50	39.50	13.46		(15.00)	0.30	4.16		80.92
18	1	Payne, Clinton	0	8787	8806									0.00
25	1	PAYNE, CARRIE	3,200	13331	13363	15.60	16.60	13.46			0.30	2.32		48.28
52	1	Pearson, Vicole	3,800	4469	4507	26.50	Exclude	13.26			0.30	2.98		43.04
40	1	Pendergrass, Angie	2,200	5042	5064	12.60	13.60	13.46			0.30	2.08		42.04
64	1	Pety, Bryan	5,900	10607	10666	29.48	Exclude	3.43			0.30	2.36	(3.43)	32.14
122	1	PETTY, ALTON	1,000	9783	9793	12.00	13.00	13.46			0.30	2.04		40.80
123	1	Pety, Jeff	2,700	9313	9340	14.10	15.10	13.46			0.30	2.20		45.16
67	1	PINKNEY, CALVIN	4,800	611	659	20.40	21.40	13.46			0.30	2.71		58.27
60	1	PINKNEY, LAMONT	2,200	5758	5780	12.60	13.60	13.46			0.30	2.08		42.04
113	1	Pittman, Tony	2,400	1681	1705	13.20	14.20	13.46			0.30	2.13		43.29
186	1	PRINCE, CAROLYN	0	0	0			12.36				0.99		13.35
145	1	PRINCE, JAMES L.	2,300	977	1000	12.90	13.90	13.46			0.30	2.11		42.67
125	1	Prince, Michael	5,300	1375	1428	21.83	22.83	13.46			0.30	2.82		61.24
148	1	Puckett, Gary	2,900	1551	1580	20.70	Exclude	Exclude			0.30	1.66		22.66
23	1	RANDLEAS, ROBER	3,200	26548	26580	21.60	Exclude	12.36	4.33		0.30	2.72	46.44	87.75
51	1	Randleas, Robert	12,800	30287	30415	47.50	Exclude	12.36	6.92		0.30	4.79	74.67	146.54
248	1	RIVERFRONT PARK	700	5962	5969	25.00	25.00	Exclude			0.30	2.00		52.30
159	1	Roberts, Jim	1,000	3594	3604	18.00	Exclude	2.83			0.30	1.44	(2.83)	19.74
207	1	Roddy, Stacy	1,400	951	965	12.00	13.00	13.46			0.30	2.04		40.80
56	1	Roddy, Jeffen	3,000	4665	4665	15.00	16.00	13.46			0.30	2.28		47.04
100	1	SAMPLE, BOBBY	3,000	2881	2911	15.00	16.00	13.46			0.30	2.28		47.04
226	1	SAMPLE, BRAD	6,200	11155	11217	24.30	25.30	13.46	6.44		0.30	3.02	67.90	140.72
104	1	Sanders, Leann	4,700	1990	2037	20.10	21.10	13.46			0.30	2.68		57.64
93	1	Schife, Charrise	4,900	579	628	20.70	21.70	13.46			0.30	2.73		58.89
2	1	SCHWEDE, BOBBY	4,600	17162	17208	19.80	20.80	13.46			0.30	2.66		57.02
74	1	Schwede, Liz	1,600	5715	5731	12.00	13.00	13.46			0.30	2.04		40.80
1	1	SCHWEDE, TOMMY	6,300	21775	21838	24.58	25.58	13.46	Exclude		0.30	3.04		66.96
54	1	SCOTT, RAYMOND	2,500	2237	2262	13.50	14.50	13.46			0.30	2.16		43.92
211	1	Richard	700	3813	3820	Exclude	13.00	3.46			Exclude	1.08	(30.75)	(3.21)

Rt	Name	Usage	Readings	Water	SEWAGE	SANITA	Late C.	Reconn	Adjust	PWSFee	Tax	PastDue	Total
47	I SIMPSON, CHAD	1,400	4892	4906	12.00	13.00	13.46			0.30	2.04		40.80
130	I SIMPSON, CHARLES	11,600	860	976	38.50	39.50	13.46			0.30	4.16		95.92
177	I Simpson, Chris 7	0	0	0						0.30	2.04		0.00
233	I SINGLETERRY, TERR	1,300	1384	1397	12.00	13.00	13.46			0.30			40.80
110	I SMITH, BRUCE	0	450	451						0.30			0.00
273	I Smith, Greg	1,000	16742	16752	12.00	13.00	13.46	5.88		0.30	2.04	61.68	108.36
14	I Smith, James A	200	359	361	12.00	13.00	13.46			0.30	2.04		40.80
112	I SMITH, DAVID	4,900	7609	7658	20.70	21.70	13.46			0.30	2.73		58.89
111	I SMITH, FREDDIE	17,200	857	1029	51.70	52.70	13.46			0.30	5.21		123.37
228	I SMITH, GEREATHA	0	7990	8063						0.30			0.00
28	I SMITH, JERRELL & A	5,400	7866	7920	22.10	23.10	13.46			0.30	2.84	(0.02)	61.78
102	I SMITH, KENT	3,300	4967	5000	15.90	16.90	13.46			0.30	2.35		48.91
90	I Spain, Mark	6,100	8183	8244	30.03	Exclde	12.36	6.18		0.30	3.39	66.68	118.94
65	I SPROLING, LAWREN	1,700	9751	9768	12.00	13.00	13.46			0.30	2.04		40.80
26	I SPROLING, MINNIE	5,200	18206	18258	21.55	22.55	13.46			0.30	2.80		60.66
156	I Stahl, Matt	0	44	157						0.30			0.00
46	I Stevenson, Marcus	100	1782	1783	18.00	Exclde	Exclde	2.57		0.30	1.44	27.71	50.02
84	I Stewart, Esther	10,800	8966	9074	36.50	37.50	13.46	12.23		0.30	4.00	(8.67)	95.32
82	I Sullivan Monroe,	600	1072	1078	12.00	13.00	13.46			0.30	2.04		40.80
88	I Sullivan, Joanne	5,900	5105	5164	23.48	24.48	13.46			0.30	2.96	(7.58)	57.10
78	I SULLIVAN, LOIS	7,800	4368	4446	28.70	29.70	13.46			0.30	3.37		75.53
37	I TALLEY, STEVEN	0	0	0	Exclde	13.00	13.46			Exclde	1.08		27.54
120	I Taylor, Bradley 3	7,700	1408	1485	28.43	29.43	13.46			0.30	3.35		74.97
36	I THOMAS, RICKY	0	0	0	Exclde		12.36			Exclde	0.99		13.35
135	I Tipton, Dylan	3,300	24370	24403	15.90	16.90	13.46			0.30	2.35	(0.62)	48.29
10	I Todd, Bobby	400	841	845	18.00	Exclde	Exclde			0.30	1.44		19.74
154	I U.S. POST OFFICE	100	9564	9565	12.00	13.00	13.46			0.30	Exclde		38.76
165	I Waites, Carl	2,000	5400	5420	18.00	Exclde	Exclde			0.30	1.44		19.74
99	I Walker, Gerald	1,700	7419	7436	12.00	13.00	13.46			0.30	2.04		40.80
218	I Wallach, Pat	700	4652	4659	18.00	Exclde	12.36			0.30	2.43		33.09
199	I Watson, Chris	100	76	77	12.00	Exclde	Exclde			0.30	0.96		13.26
197	I WATSON, MARY	3,900	11004	11043	17.70	18.70	13.46			0.30	2.49		52.65
29	I WATSON, RICHARD	2,800	937	965	14.40	15.40	13.46			0.30	2.23		45.79
263	I Weatherly, Fred	0	3604	3604	18.00	Exclde	Exclde			0.30	1.44	(29.17)	(9.43)
152	I Wedell, Henri	0	5245	5250		Exclde	Exclde			0.30			0.00
160	I White River Dairy Bar	76,800	84804	85572	191.80	Exclde	Exclde			0.30	15.34		207.44
117	I WHITE, BILLY	3,500	190	225	16.50	17.50	13.46			0.30	2.40		50.16
41	I White, Tanner	2,300	5543	5566	12.90	13.90	13.46			0.30	2.11		42.67
150	I WILKINSON, PAT	3,100	4949	4980	15.30	16.30	13.46	5.88		0.30	2.30	61.68	115.22
178	I Willeford, Joe	6,900	5402	5471	Exclde	27.23	13.46			Exclde	1.08		41.77
134	I WILLEFORD, STEVE	1,400	36	50	12.00	13.00	13.46			0.30	2.04		40.80
133	I WILLEFORD, WILLA	4,600	13767	13813	19.80	20.80	13.46			0.30	2.66		57.02
137	I Williams, Davey	6,600	15348	15414	25.40	26.40	13.46			0.30	3.11		68.67
83	I Williams, John	10,700	9953	10060	36.25	37.25	13.46			0.30	3.98		91.24
139	I W s, Marty	800	749	757	12.00	13.00	46			0.30	2.04		40.80

Acct	Rt	Name	Usage	Readings	Water	SEWAGE	SANITA	Late C	Reconn	Adjnst	PWSFee	Tax	PastDue	Total
216	1	WILLIAMS, I.E.	0	0	0									0.00
153	1	WILLIAMS, REX	2,700	7150	7177	14.10	15.10	13.46			0.30	2.20		45.16
175	1	WILLIAMS, WILLIEM	0	3325	3416									0.00
149	1	Willimas, Jeff	1,600	187	203	12.00	13.00	13.46			0.30	2.04		40.80
255	1	WOODALL, LEAH	4,500	4144	4189	19.50	20.50	13.46			0.30	2.64		56.40
205	1	Wright, Alessia	2,600	2916	2942	13.80	14.80	13.46			0.30	2.18		44.54
17	1	WRIGHT, MARTHA C	3,300	6456	6489	15.90	16.90	13.46			0.30	2.35		48.91

9/26/2017 4:20:06PM

WATER

Billing Register Summary

Water \$3,581.94
 SEWAGE \$3,293.71
 SANITATION \$2,272.40
 Late Charge \$254.42
 Reconnect Fee (\$32.35)
 Adjustments \$54.60
 PWS Service Fee \$464.90
 Tax

unified By: All Customers
 ity of Biscoe .

Total Current Charges \$9,889.62
 Past Due \$1,705.38
 Prepay/Overpay (\$216.76)
 Total Receivables \$11,378.24

Total Usage 229
 Accounts Listed 852,000

EXHIBIT "2"

EAST PRAIRIE COUNTY WATER SYSTEM CUSTOMER LIST

EAST PRAIRIE COUNTY WATER ASSOC.

Customer List

All Customers
Sorted by Route + Read Seq
For Route B

Account No.	Customer Name	Billing Address	City/State	Bill Pref.	Home Phone	Work Phone	Work Ext.
Cell Phone	E-mail						
FARRIS R001	FARRIS, RITA	P.O. BOX 403	BISCOE, AR 72017-	B			
MATHIS AN01	MATHIS, STEVE & ANNY	PO BOX 125	BISCOE, AR 72017-	B			
DAVES DAL02	DAVES, DALTON	5401 N SHORE COVE	NORTH LITTLE ROCK,	B	(501)940-3258		
WILLAFORD KI	WILLAFORD, KENDRA	PO BOX 285	BISCOE, AR 72017-	B			
HOLMES CH01	HOLMES, CHARLES	P. O. BOX 363	BISCOE, AR 72017-	B			
SEAT	SEAT, RICHARD	1279 HWY 33	BISCOE, AR 72017-	B	(907)715-8326		
	(907)715-8327						
PATTERSON T	PATTERSON, TONY	1280 HWY 33 S	BISCOE, AR 72017-	B			
PATTERS JA01	PATTERSON, REBECCA	P. O. BOX 184	BISCOE, AR 72017-	B			
BETZNER PA01	BETZNER, PAUL	P.O. BOX 321	BISCOE, AR 72017-	B			
WILLIAMSIB02	WILLIAMS, ISSACH	767 BISCOE FARM RD	BISCOE, AR 72017-	B			
WILLIAMS IB	ALBERSON, JAMES	567 S BISCOE FARM RD	BISCOE, AR 72017-	B			
WILSON	WILSON, OBRALD	531 S BISCOE FARM RD	BISCOE, AR 72017-	B			
HAMILTON	HAMILTON, DAVID	141 SHERRY LANE	KARNACK, TX 75661-	B			
MERTENS	MERTENS, MARCELLIS	595 CHESSER RD	BISCOE, AR 72017-	B			
MERTEN CL02	MERTENS, JONATHAN	655 CHESSER RD	BISCOE, AR 72017-	B			
MERTENS	MERTENS, GLENN		BISCOE, AR 72017-	B			
JOSHLIN CORD	JOSHLIN, CORDELL	677 CHESSER RD	BISCOE, AR 72017-	B			
ROUSH TA01	ROUSH, TAMMY	709 CHESSER RD	BISCOE, AR 72017-	B			
TAYLOR PHILL	TAYLOR, PHILLIP	336 BISCOE FARM RD	BISCOE, AR 72017-	B			
BRANNON	BRANNON, BETTY	370 N BISCOE FARM RD	BISCOE, AR 72017-	B			
HALL DE01	HALL, DELLA	396 N BISCOE FARM RD	BISCOE, AR 72017-	B			
NAIL AU01	NAIL, AUSTIN	401 COOK RD	BISCOE, AR 72017-	B			
PRINCE WO	GOLDEN, KAREN	322 COOK RD	BISCOE, AR 72017-	B			
TAYLOR	TAYLOR, CANDICE	230 COOK RD	BISCOE, AR 72017-	B			
CAMPBELL	CAMPBELL, LESTER	125 COOK RD	BISCOE, AR 72017-	B			
BROWN MA01	BROWN, MAXINE	974 N. BISCOE FARM RD	BISCOE, AR 72017-9702	B			
DUNCAN	DUNCAN, DAVID	1000 N. BISCOE FARM	BISCOE, AR 72017-	B			
COOK RU01	VOLNER, JEFF	3030 BALFOUR	WEST MEMPHIS, AR	B			
THOMAS JO01	THOMAS, JOHNNY	1114 N BISCOE FARM RD	BISCOE, AR 72017-	B			
	(501)920-5410						
HUBBARD	HUBBARD, JAMES	HCR 88 BOX 76 A	BISCOE, AR 72017-	B			

Account No. Cell Phone	Customer Name E-mail	Billing Address	City/State	Bill Pref.	Home Phone	Work Phone	Work Ext.
COOK R001	COOK, BILLY W	1261 N BISCOE FARM RD	BISCOE, AR 72017-	B			
HURT J01	HURT, JIM	10498 BRASEFIELD RD	BISCOE, AR 72017-	B			
SAYGER PA01	SAYGER, PAUL	P. O. BOX 314	BISCOE, AR 72017-	B			
MCKENZIE LE01	MCKENZIE, LONA	14098 BRASEFIELD RD	BISCOE, AR 72017-	B			
SAYGER	SAYGER, ANDY	10660 BRASEFIELD RD	BISCOE, AR 72017-	B			
SAYGER M01	SAYGER, MICHAEL	10680 BRASEFIELD RD	BISCOE, AR 72017-	B			
SAYGER DA01	CLARK, DANESS	10702 BRASEFIELD RD	BISCOE, AR 72017-	B			
PRINCE CA01	PRINCE, CAROLYN	11122 BRASEFIELD ROAD	BISCOE, AR 72017-	B			
HOLLOWAY CL	HOLLOWAY, SHARON	929 METHODIST RD	BISCOE, AR 72017-	B			
HOLLOWA	HOLLOWAY, CORINE	922 METHODIST RD	BISCOE, AR 72017-	B			
WHITE ROSIE	WHITE, ROSIE	862 METHODIST RD	BISCOE, AR 72017-	B			
METHODIST	FIRST UNITED	389 W PRAIRIE ST	DEVALLSBLOFF, AR	B			
ALBERSO BI01	ALBERSON, BILLY	P. O. BOX 110	BISCOE, AR 72017-	B			
PRINCE WO 02	LUNDELL FARMS,	PO BOX 3417	LITTLE ROCK, AR 72203-	B	(501)320-0555		
HESTER ERIN	HESTER, ERIN	PO BOX 175	BISCOE, AR 72017-	B	(870)660-9160		
WYLIE BEN	WYLIE, BEN	2 LONGWOOD RD	LITTLE ROCK, AR 72223-	B	(501)680-4705		
MILLER PE01	MILLER, PBTB	11468 MOORE RD	BISCOE, AR 72017-	B			
BOKKER FR01	BOKKER, FRANK	307 DRYE RD	BISCOE, AR 72017-	B			
DAVENPORT	DAVENPORT, LANA	11091 BRASEFIELD RD	BISCOE, AR 72017-	B	(870)734-6402		
HOLLOWA	HOLLOWAY, TRAVIS	11237 HOLLOWAY RD	BISCOE, AR 72017-	B			
DAVENPORT	DAVENPORT, LANA		BISCOE, AR 72017-	B			
JONES SABRIN	JONES, SABRINA	HOLLOW BRASEFIELD	BISCOE, AR 72017-	B			
MERTENS	MERTENS, CONNIE	13757 HWY 70 E	BISCOE, AR 72017-	B	(870)468-8030		
PRINCEBILL02	PRINCE, W.O.	645 DRYE RD	BISCOE, AR 72017-	B	(501)438-1305		
COOK PH01	COOK, PHYLLIS	P. O. BOX 343	BISCOE, AR 72017-	B			
SEE JOHN	SEE, JOHN	PO BOX 167	CABOT, AR 72023-	B	(501)416-7342		

Total Customers 100

EXHIBIT "3"

BISCOE WATER SYSTEM MAP OF AFFECTED AREAS

The fire
line of Interstate.



EXHIBIT "4"

EAST PRAIRIE COUNTY WATER SYSTEM MAP OF AFFECTED AREAS

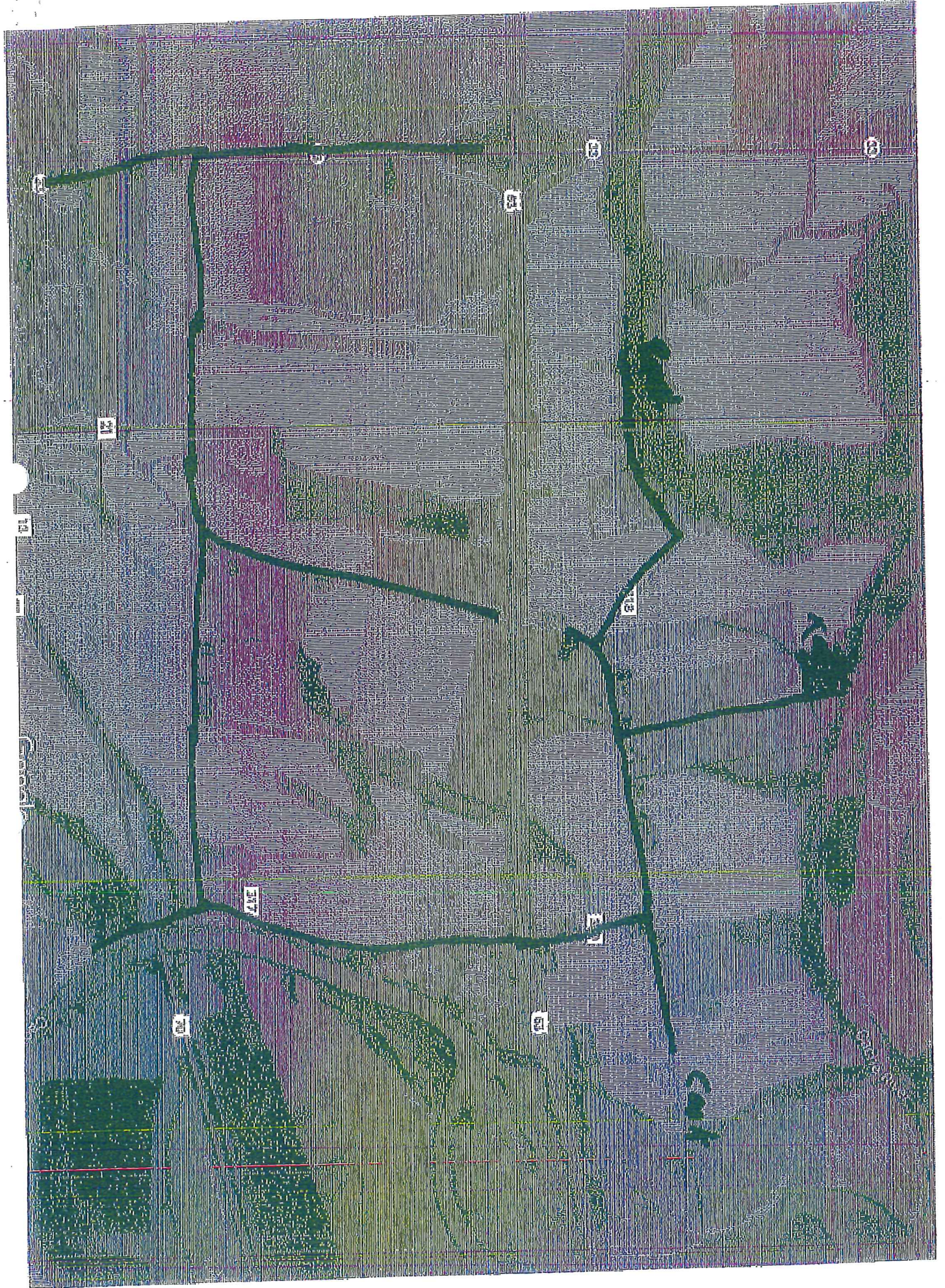

123

456

CITY

1

2

3

4

5

6

7

8

9

10

11

12

13

14

15

16

17

18

19

20

21

22

23

24

25

26

27

28

29

30

31

32

33

34

35

36

37

38

39

40

41

42

43

44

45

46

47

48

49

50